



SINCE 1975

DSC ALL STAINLESS STEEL FLOAT & THERMOSTATIC STEAM TRAPS

No. FSS2~FSS5VF

MOP 32K x 320°C



- ALL STAINLESS STEEL BODY SUITABLE FOR LOW & MEDIUM PRESSURE SERVICE.
- LARGE AMOUNT VENTING CAPABILITY OF COLD AIR WHEN STARTS UP.
- CONTINUOUS DISCHARGE OF CONDENSATE.
- ALL STAINLESS STEEL PARTS ARE GOOD FOR CORROSION RESISTANCE AND LONGER SERVICE YEARS.
- CONTINUOUS DISCHARGE DELIVER SMALLER NOISE.
- BEST CHOICE FOR SERVICE OF STEAM MODUL CONTROL SYSTEM.
- INTERNAL PARTS ARE REPLACEABLE.

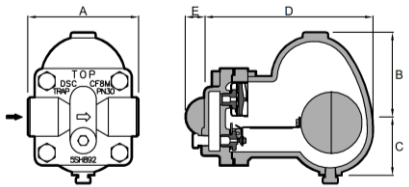

No.FSS2 · FSS5

No. FSS2 · FSS5 DIMENSIONS(MM). MOP(KG/CM²). WT(KG)

No.	CONN.SE*	A	B	C	D	E	MOP	WT.
FSS2	15.20.25	125	70	60	150	22	17	3.5
FSS5	15.20.25	125	97	61	191	22	32	5

* NPT. PT. SW AVAILABLE.

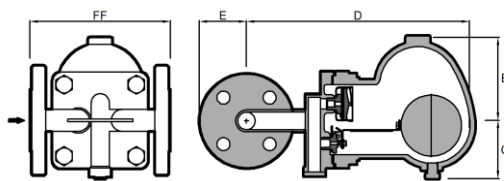

No.FSS2F · FSS5F

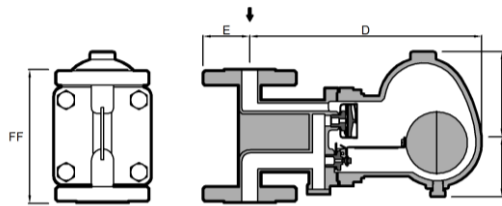

No.FSS2VF · FSS5VF

No.FSS2F~FSS5VF

No.	CONN.FE*	FF	B	C	D	E	MOP	WT.
FSS2F·FSS2VF	15.20/25	150/160	70	60	150	53	17	5.7/6.0
FSS5F·FSS5VF	15.20/25	150/160	97	61	190	53	32	7.2/7.5

*DIN FLANGE STANDARD. OTHER SPEC. CONSULT FACTORY.

CONSTRUCTION OF MATERIALS

CAP & BODY	CF8
SEAT & VALVE	CHROME STEEL HARDEND
MECHANISM	S.S.304
FLOAT	S.S.304
AIR VENT CAGE	S.S.304
DIFFUSER	S.S.304
BOLTS & NUTS	S.S.304

CONDENSATE DISCHARGE CAPACITY IN KG/HR.

